



**MASSLOAD**

# CI-113

## 1xGE 60W UPoE Injector Technical Specifications



Model	CI-113
<b>IP Camera Compatibility</b>	
Video Resolution	Megapixel/D1/VGA
Video Compression	MJPEG/MPEG-4/H.264/H.265
Compatible Camera List	Outdoor Enclosures: CI-701 PoE Housing, CI-700 PoE Housing
<b>Ethernet</b>	
Gigabit Ethernet (RJ45)	1
<b>Standards</b>	
IEEE 802.3 10-BASE-T (Ethernet)	Supported
IEEE 802.3u 100-BASE-TX (Fast Ethernet)	Supported
IEEE 802.3ab 1000-BASE-T (Gigabit Ethernet)	Supported
IEEE 802.3af Power over Ethernet	Supported
IEEE 802.3at Power over Ethernet	Supported
<b>Transmission Media</b>	
10Base T	Cat. 3, 4, 5 UTP/STP
100Base TX	Cat. 5, 5e UTP/STP
1000Base T	Cat. 5e, 6, 7 UTP/STP
*It is highly recommended to use standard Cat. 5e/6/7 cables which are compliant with the 3P/ETL standard.	
<b>PoE Function</b>	
Number of PoE Out Ports	1

PoE Output Power	54VDC/60W
802.3at Standard Compatible	Yes
802.3af Standard Compatible	Yes
Over Current Protection	Supported
Circuit Shorting Protection	Supported
Power Pin Assignment	1/2(-), 3/6(+), 4/5(+), 7/8(-)
PoE PD Auto Detection	Supported
<b>General</b>	
LED Indicators	Power, PoE
Power Input	100~240VAC / 50~60Hz
Power Consumption	65W
Dimensions	153 (L) x 84 (W) x 44 (H) mm
Weight	0.4 kg
Operating Temperature	0°C ~ 50°C (32°F ~ 122°F)
Storage Temperature	-20°C ~ 70°C (-4°F ~ 158°F)
Humidity	Operating: 10~90% (Non-condensing) Storage: 10~90% (Non-condensing)
Safety Certifications	CE, C-Tick, FCC, VCCI, LVD
<b>Application</b>	
Indoor	

### Dimensions

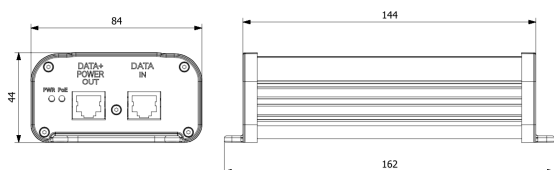

### Connection

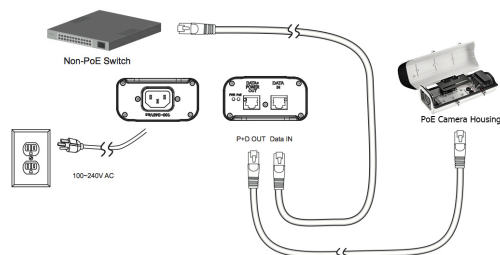

All specifications are subject to change without notice.

[www.massload.com.tw](http://www.massload.com.tw)